

FC | CYLINDRICAL SINGLE NUT WITH THREAD FOR ROLLED SCREWS

1

DIFFERENT PITCH AND DIMENSIONS ARE AVAILABLE UPON REQUEST. DIMENSIONS IN INCHES ARE ALSO AVAILABLE / *NON-NORMALIZED TYPES

TYPE	d_o	P_h	D_w	N	D	D_1	D_2	L	L_1	L_2	C_o	C_a	R_c
FC1405	14	5	3,175	2	24	M20x1,5	/	34	10	/	846	730	14
FC1605		5	3,175	3	32	M30x1,5	M6	51	16	9	1191	1160	21
FC1610	16	10	3,175	3	32	M30x1,5	M6	68	16	9	1191	1160	21
FC1616		16	3	2	33	M30x1,5	M6	49	16	9,5	887	783	16
FC2005	20	5	3,175	4	38	M35x1,5	M6	56	16	9	1985	1525	33
FC2505		5	3,175	5	42	M40x1,5	M6	63	17	9	3178	1920	40
FC2506		6	3,969	4	42	M40x1,5	M6	68	20	10	3105	2439	41
FC2510-3		10	4,762	3	42	M40x1,5	M6	74,5	17,5	10	2713	2628	32
FC2510-4		10	4,762	4	42	M40x1,5	M6	87	20	10	3346	3242	40
FC3205		5	3,175	5	52	M48x1,5	M6	66	20	10	4361	2063	59
FC3206	32	6	3,969	4	52	M48x1,5	M6	68	20	10	4221	2618	51
FC3210		10	6,35	4	52	M48x1,5	M6	90	20	10	5876	5254	51
FC4005		5	3,175	5	60	M56x1,5	M6	66	20	10	5722	2204	71
FC4010		10	6,35	5	65	M60x1,5	M8x1	110	25	16	9377	6611	75
FC5010	50	10	6,35	5	78	M72x1,5	M8x1	115	30	16	12714	7050	92

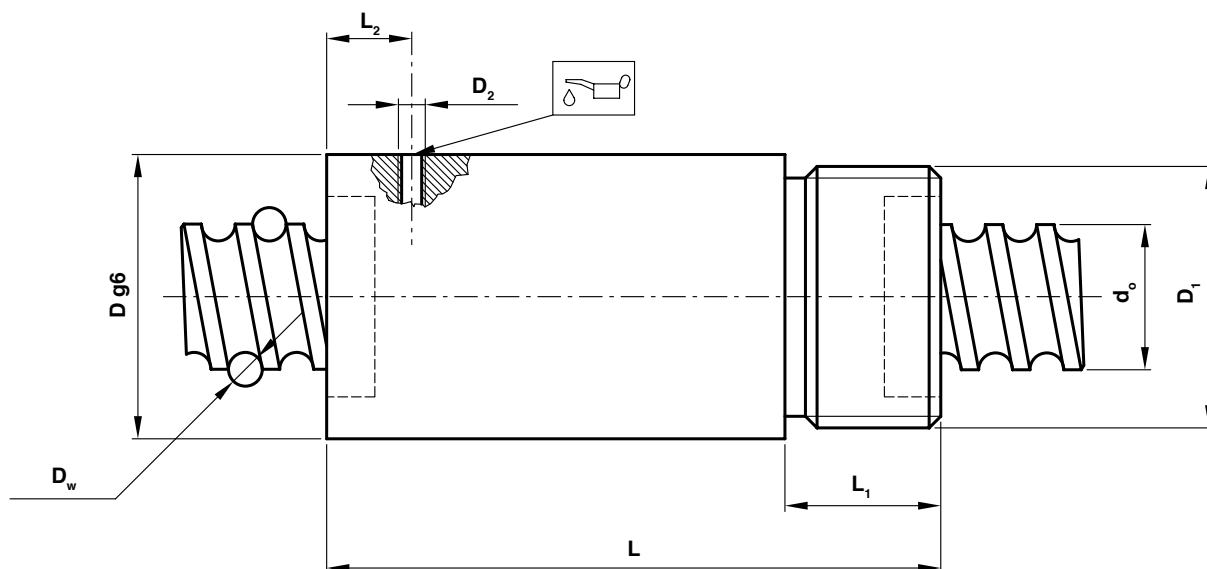

- N Nr of ball screw revolutions
- H Flange type
- d_o Major diameter (mm)
- P_h Pitch (mm)
- D_w Ball diameter (mm)
- C_o Static load capacity (daN)
- C_a Dynamic load capacity (daN)
- R_c Nut rigidity (daN/ μ m)

OFFICINA MECCANICA B.B.
WWW.OFFICINAMECCANICABB.COM

